

Pin	Dimensions(mm)	
	A	B
02	2.54	5.08
03	5.08	7.62
04	7.62	10.16
05	10.16	12.70
06	12.70	15.24
07	15.24	17.78
08	17.78	20.32
09	20.32	22.86
10	22.86	25.40
11	25.40	27.94
12	27.94	30.48
13	30.48	32.02
14	32.02	35.56
15	35.56	38.10
16	38.10	40.64
17	40.64	43.18
18	43.18	45.72
19	45.72	48.26
20	48.26	50.80

Material:
 Housing: PA66, UL 94 V-0
 Colour: Natural or Beige
 Pin: Brass, Tin Plated

Electrical Characteristics:
 Rated Current: 2.0AMP
 Voltage rating: 250V AC, DC
 Temperature range: -25°C ~ 85°C
 Insulator Resistance: 1000MΩ Min
 Withstanding Voltage: 1000V AC/minute
 Contact Resistance: 10mΩ Max

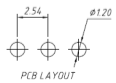
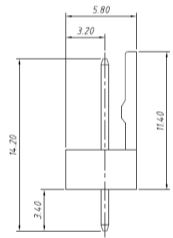
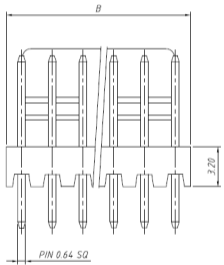

ANGLE TOLERANCE	PROJECTION	Description
±3°		2.54mm 2510 Wire To Board Connector
GENERAL TOLERANCE	UNITS	mm
x.x	±0.30	SHEET SIZE A4
x.xxx	±0.20	Draw: 2021-01-11
x.xxxx	±0.10	Check: 2021-01-11